

ArcticDraft™ Remote Root Beer Systems Model 11M



Multiplex



ArcticDraft™ root beer system provides the most consistent, highest quality root beer in the industry.

- Remote recirculation system keeps carbonated water and syrup chilled from location of the refrigeration unit to beverage dispensers.
- All water used for cooling drinks is recycled with virtually no waste water; reduces water and sewage expenses.

- Reduced ice consumption compared to coldplate systems.
- Durable, easy to clean stainless steel cabinet.
- Reduced counter space needed compared to coldplate systems.
- Environmentally friendly R-404A refrigerant.



ISO 9001:2000
Quality System Certified

High Volume Dispensing Solutions

Remote Recirculation Soda Systems • Long Draw Beer Systems • Pre-Chillers

Manitowoc

ArcticDraft™ Remote Root Beer Systems • Model 11M

Specifications

Model 11M

Standard Features	Internal cold carbonation, recirculation pump, stainless steel cabinet
Electrical Requirements	120V/60Hz/1/21.5 / 230V/50Hz/1/10.7
Compressor	1/2 hp / .97 kw
Shipping Weights (Approximate)	230 lbs / 104 kgs
Ice Bank Size (Nominal)	60 lbs / 18.14 kgs
Condenser (Self-contained)	Air Cooled
Conduit (Maximum Run)	100 ft / 43 m
Evaporator Rating (20°F / -6.5°C)	5,150 BTUH / 1,159 kcal/hr
Heat Rejection (Maximum)	8,638 BTUH / 1,949 kcal/hr
Syrup Coils (Standard/Maximum)	6 / 8
Drink Capacity (12 oz. dispensed at or below 40°F / 75°F Ambient, 2.4°C)	340 per hour for 2 hours / 185 per hour continuous
Options	Wall mount shelf, legs, stand, condenser filter, casters, and additional syrup coils.

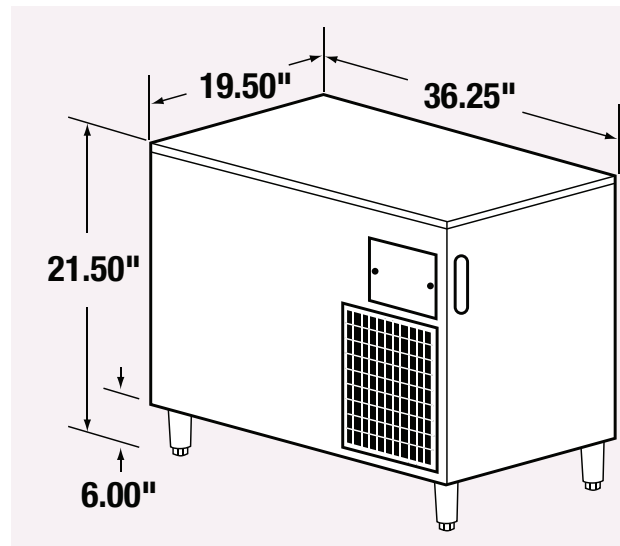
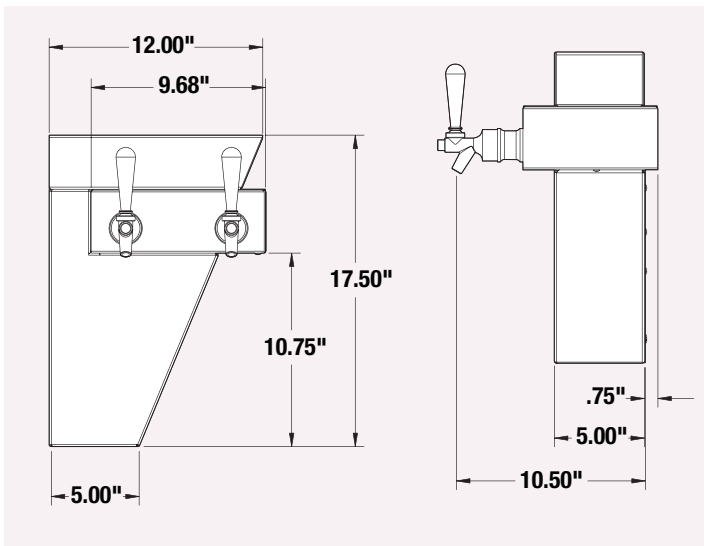

4083A ©2008 Multiplex 7/08 Continuing product improvement may necessitate change of specifications without notice.



MANITOWOC BEVERAGE
EQUIPMENT, INC.
2100 Future Drive
Sellersburg, IN 47172, USA
Ph: 800-367-4233 • Fax: 812-246-7024
Visit us online at www.manitowocbeverage.com

